



# ZWBPD020020

## Gearbox specifications

Outer diameter	20mm	Bearing	Porous bearing	Rolling bearing
Material	Plastic	Axial endplay	≤0.1mm	≤0.1mm
Direction of rotation	cw & ccw	Radial loading on output shaft	≤30N	≤50N
Gear backlash	≤3° (Customisable)	Operating temperature range	-20~ +85°C	

## Gearbox stages

	1	2	3	4
Reduction ratio	4 / 6	16 / 24 / 36	64 / 96 / 144 / 216	256 / 384 / 576 / 864 / 1296
Max rated torque of gearbox (gf.cm)	6000	6000	6000	6000
Instant torque of gearbox (gf.cm)	15000	15000	15000	15000
Gearbox efficiency	85	73	65	58
Length L1 (mm)	17.6	22.9	28.2	33.5

## Technical illustrations

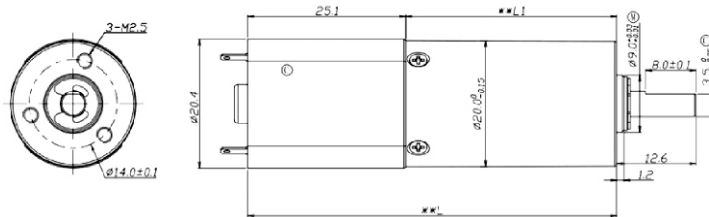

## Motor specifications

Motors	Coreless motor, brushless motor, Stepper motor	Input speed	≤15000rpm
Voltage(Optional)	3-24V	Current	300mA max

Reference data (motor definition value): 12v 7200rpm The following table is tested according to the motor definition value, the data is only for reference

Model	Rated Speed	Max Speed	Max Rated Torque	Max Instant Torque	Reduction ratio	Length L1	Overall Length
	rpm	rpm	gf.cm	gf.cm			
ZWBPD020020-4	1875	7500	6000	15000	4	17.6	42.7
ZWBPD020020-6	1250	5000	6000	15000	6		
ZWBPD020020-16	469	1875	6000	15000	16	22.9	48
ZWBPD020020-24	313	1250	6000	15000	24		
ZWBPD020020-36	208	833	6000	15000	36		
ZWBPD020020-64	117	469	6000	15000	64	28.2	53.3
ZWBPD020020-96	78	313	6000	15000	96		
ZWBPD020020-144	52	208	6000	15000	144		
ZWBPD020020-216	35	139	6000	15000	216		
ZWBPD020020-256	29	117	6000	15000	256	33.5	58.6
ZWBPD020020-384	20	78	6000	15000	384		
ZWBPD020020-576	13	52	6000	15000	576		
ZWBPD020020-864	9	35	6000	15000	864		
ZWBPD020020-1296	6	23	6000	15000	1296		

Please contact us for customized products: [contact@zw-drive.com](mailto:contact@zw-drive.com)