



# ZWBPD010010

## Gearbox specifications

Outer diameter	10mm	Bearing	Porous bearing	Rolling bearing
Material	Plastic	Axial endplay	≤0.3mm	≤0.2mm
Direction of rotation	cw & ccw	Radial loading on output shaft	≤1N	≤7N
Gear backlash	≤3° (Customisable)	Operating temperature range	-20~ +85°C	

## Gearbox stages

	1	2	3	4
Reduction ratio	4 / 6	13 / 19 / 28	46 / 69 / 102 / 151	168 / 249 / 368 / 546 / 809
Max rated torque of gearbox (gf.cm)	600	600	600	850
Instant torque of gearbox (gf.cm)	1200	1200	1200	1700
Gearbox efficiency	85	73	65	58
Length L1 (mm)	9.7	12.8	15.9	19

## Technical illustrations

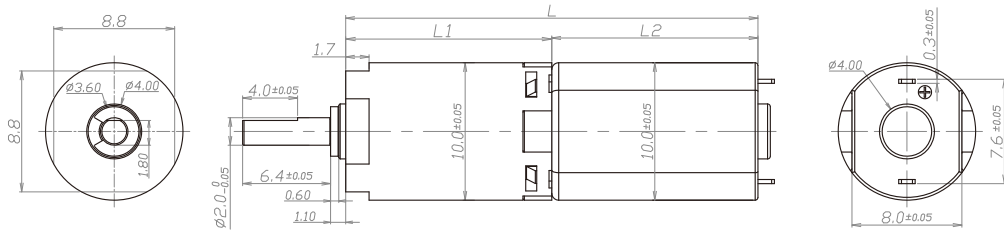

## Motor specifications

Motors	DC brush motor, DC brushless motor, Stepper motor	Input speed	≤30000rpm
Voltage(Optional)	3-24V	Current	150mA max

Model	Rated Speed	Max Speed	Max Rated Torque	Max Instant Torque	Reduction ratio	Length L1	Overall Length
	rpm	rpm	gf.cm	gf.cm			
ZWBPD010010-4	1875	7500	600	1200	4	9.7	24.7
ZWBPD010010-6	1250	5000	600	1200	6		
ZWBPD010010-13	577	2308	600	1200	13	12.8	27.8
ZWBPD010010-19	395	1579	600	1200	19		
ZWBPD010010-28	268	1071	600	1200	28		
ZWBPD010010-46	163	652	600	1200	46	15.9	30.9
ZWBPD010010-69	109	435	600	1200	69		
ZWBPD010010-102	74	294	600	1200	102		
ZWBPD010010-151	50	199	600	1200	151		
ZWBPD010010-168	45	179	850	1700	168	19	34
ZWBPD010010-249	30	120	850	1700	249		
ZWBPD010010-368	20	82	850	1700	368		
ZWBPD010010-546	14	55	850	1700	546		
ZWBPD010010-809	9	37	850	1700	809		

Please contact us for customized products: [contact@zw-drive.com](mailto:contact@zw-drive.com)