



ZWMD012012

Gearbox specifications

Outer diameter	12mm	Bearing	Porous bearing	Rolling bearing
Material	Metal	Axial endplay	≤0.1mm	≤0.1mm
Direction of rotation	cw & ccw	Radial loading on output shaft	≤10N	≤20N
Gear backlash	≤3° (Customisable)	Operating temperature range	-20~ +85°C	

Gearbox stages

	1	2	3	4
Reduction ratio	4 / 6	16 / 24 / 36	64 / 96 / 144 / 216	256 / 384 / 576 / 864 / 1296
Max rated torque of gearbox (gf.cm)	2000	2000	2000	2000
Instant torque of gearbox (gf.cm)	6000	6000	6000	6000
Gearbox efficiency	87	74	63	56
Length L1 (mm)	12.4	16.2	20	23.8

Technical illustrations

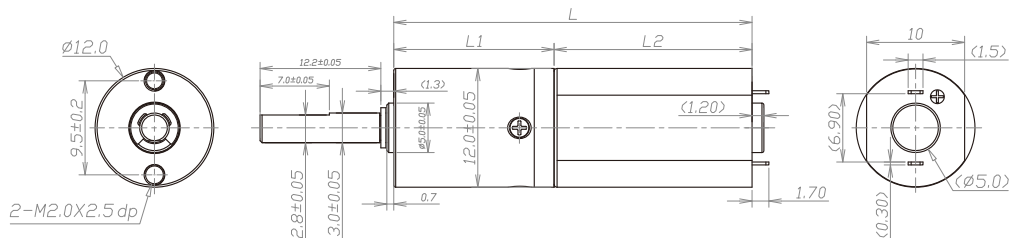

Motor specifications

Motors	DC brush motor, DC brushless motor, Stepper motor	Input speed	≤30000rpm
Voltage(Optional)	3-24V	Current	250mA max

Model	Rated Speed	Max Speed	Max Rated Torque	Max Instant Torque	Reduction ratio	Length L1	Overall Length
	rpm	rpm	gf.cm	gf.cm		mm	mm
ZWMD012012-4	1875	7500	2000	6000	4	12.4	32.4
ZWMD012012-6	1250	5000	2000	6000	6		
ZWMD012012-16	469	1875	2000	6000	16	16.2	36.2
ZWMD012012-24	313	1250	2000	6000	24		
ZWMD012012-36	208	833	2000	6000	36		
ZWMD012012-64	117	469	2000	6000	64		
ZWMD012012-96	78	313	2000	6000	96	20	40
ZWMD012012-144	52	208	2000	6000	144		
ZWMD012012-216	35	139	2000	6000	216		
ZWMD012012-256	29	117	2000	6000	256		
ZWMD012012-384	20	78	2000	6000	384	23.8	43.8
ZWMD012012-576	13	52	2000	6000	576		
ZWMD012012-864	9	35	2000	6000	864		
ZWMD012012-1296	6	23	2000	6000	1296		

Please contact us for customized products: contact@zw-drive.com