

16
mm**M**
Metal

ZWMD016016

Gearbox specifications

Outer diameter	16mm	Bearing	Porous bearing	Rolling bearing
Material	Metal	Axial endplay	≤0.1mm	≤0.1mm
Direction of rotation	cw & ccw	Radial loading on output shaft	≤20N	≤30N
Gear backlash	≤2° (Customisable)	Operating temperature range	-30~ +100°C	

Gearbox stages

	1	2	3	4
Reduction ratio	4 / 6	16 / 24 / 36	64 / 96 / 144 / 216	256 / 384 / 576 / 864 / 1296
Max rated torque of gearbox (gf.cm)	5000	5000	5000	5000
Instant torque of gearbox (gf.cm)	10000	10000	10000	10000
Gearbox efficiency	90	85	80	75
Length L1 (mm)	11.5	14.8	18.1	21.4

Technical illustrations

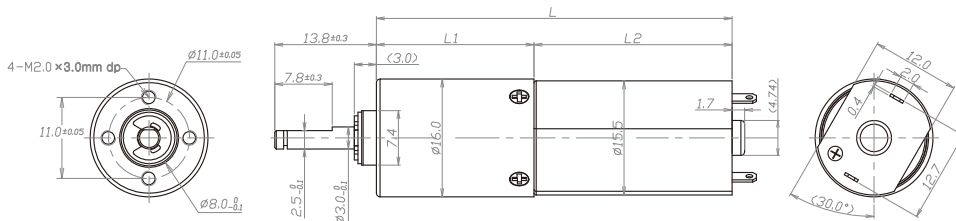

Motor specifications

Motors	Coreless motor, brushless motor, Stepper motor	Input speed	≤15000rpm
Voltage(Optional)	3-24V	Current	300mA max

Reference data (motor definition value): 6v 8000rpm The following table is tested according to the motor definition value, the data is only for reference

Model	Rated Speed	Max Speed	Max Rated Torque	Max Instant Torque	Reduction ratio	Length L1	Overall Length
	rpm	rpm	gf.cm	gf.cm			
ZWMD016016-4	1875	7500	5000	10000	4	11.5	38.4
ZWMD016016-6	1250	5000	5000	10000	6		
ZWMD016016-16	469	1875	5000	10000	16	14.8	41.7
ZWMD016016-24	313	1250	5000	10000	24		
ZWMD016016-36	208	833	5000	10000	36		
ZWMD016016-64	117	469	5000	10000	64	18.1	45.0
ZWMD016016-96	78	313	5000	10000	96		
ZWMD016016-144	52	208	5000	10000	144		
ZWMD016016-216	35	139	5000	10000	216		
ZWMD016016-256	29	117	5000	10000	256	21.4	48.3
ZWMD016016-384	20	78	5000	10000	384		
ZWMD016016-576	13	52	5000	10000	576		
ZWMD016016-864	9	35	5000	10000	864		
ZWMD016016-1296	6	23	5000	10000	1296		

Please contact us for customized products: contact@zw-drive.com

ZW DRIVE
ZHAOWEI

ZW Drive GmbH
Alte Marktoberdorfer Strasse 14
87616 Marktoberdorf · Germany

Tel. +49 89 6600 2375
contact@zw-drive.com
www.zw-drive.com